

# AUTOCOLLIMATORS

## FOCUSABLE – WITH CCD-CAMERA MOUNT

### Description:

For a general description of the principle of functioning of focusable autocollimators see page 43.

The eyepiece and the eyepiece reticle are replaced by a mount for a C-Mount-CCD-camera and the autocollimation image is directly imaged on the camera chip when it is mounted.

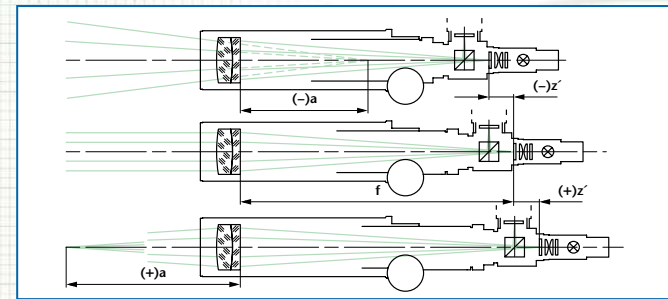

### Application areas:

- Adjustment of optical and mechanical systems
- Qualitative testing of the imaging properties of optical elements and systems
- Measurement of large radii of curvature
- Infinity adjustment to other wavelengths

### Notes on ordering:

- The CCD-camera and computer hardware/software are NOT included.
- As this type of autocollimator does not have an eyepiece reticle a direct measurement of the reticle displacement is impossible. Additional computer with software and frame grabber is needed.

### More notes on ordering:

- Collimator reticle and 6V/5W illumination w/cord are included.
- For angular measurement the autocollimator should be equipped with a negative crosshair reticle (see page 83). For testing of imaging quality use resolution target or Siemens Star (see page 87).
- The nomenclature of the adjustable autocollimators with CCD-camera mount is as follows:

Example: AK R V 90/ 40/ ±6 CCD

Autocollimator  
 90° viewing  
 Variable  
 Focal length  
 Tube diameter  
 Tube extension in mm  
 CCD-Camera mount

### Important:

Please specify collimator reticle (see page 82) as well as illumination (LED-, bulb- or cold light, see page 81) when ordering.

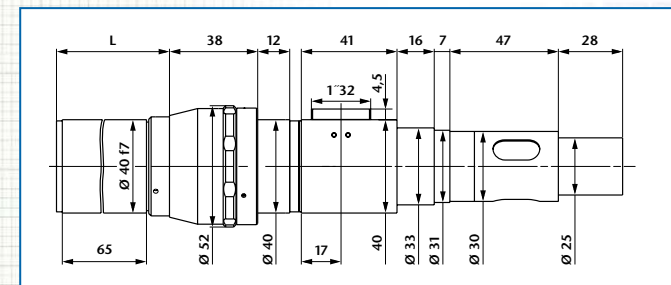

Ord.-No.	Description	Focal length	Free aperture	Tube extension	Meas. range*	Distance range	L
229 471	AKRV 90/40/±6 CCD	90	16	±6	x:2,50° y:1,80°	-∞...-1,25 m 1,40 m...+∞	77±6
229 472	AKRV 90/40/+12 CCD	90	16	+12	x:2,50° y:1,80°	0,80 m...+∞	71 <sup>+12</sup>
229 473	AKRV 90/40/-12 CCD	90	16	-12	x:2,50° y:1,80°	-∞...-0,60 m	83 <sup>-12</sup>
229 474	AKRV 140/40/±6 CCD	140	28	±6	x:1,60° y:1,20°	-∞...-3,10 m 3,30 m...+∞	77±6
229 475	AKRV 140/40/+12 CCD	140	28	+12	x:1,60° y:1,20°	1,70 m...+∞	71 <sup>+12</sup>
229 476	AKRV 140/40/-12 CCD	140	28	-12	x:1,60° y:1,20°	∞...-1,40 m	83 <sup>-12</sup>

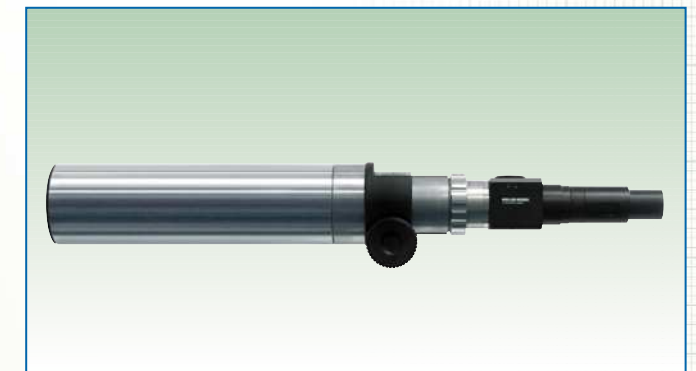
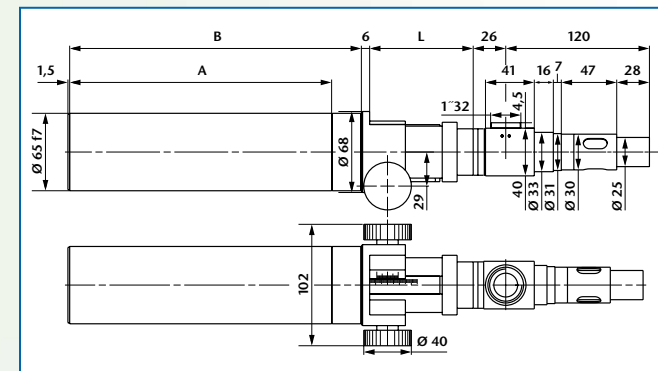

Ord.-No.	Description	Focal length	Free aperture	Tube extension	Meas. range*	Distance range	A	B	L
229 477	AKRV 300/65/±25 CCD	300	50	±25	x:2,50° y:1,80°	-∞...-3,4 m 3,8 m...+∞	220	245	87±25
229 478	AKRV 300/65/+50 CCD	300	50	+50	x:2,50° y:1,80°	2,1 m...+∞	220	270	62 <sup>+50</sup>
229 479	AKRV 300/65/-50 CCD	300	50	-50	x:2,50° y:1,80°	-∞...-1,5 m	220	220	112 <sup>-50</sup>
229 480	AKRV 500/65/±50 CCD	500	50	±50	x:2,50° y:1,80°	-∞...-4,5 m 5,4 m...+∞	310	360	112±50
229 481	AKRV 500/65/+100 CCD	500	50	+100	x:2,50° y:1,80°	3,0 m...+∞	310	410	62 <sup>+100</sup>
229 482	AKRV 500/65/-100 CCD	500	50	-100	x:2,50° y:1,80°	-∞...-1,5 m	310	310	162 <sup>-100</sup>

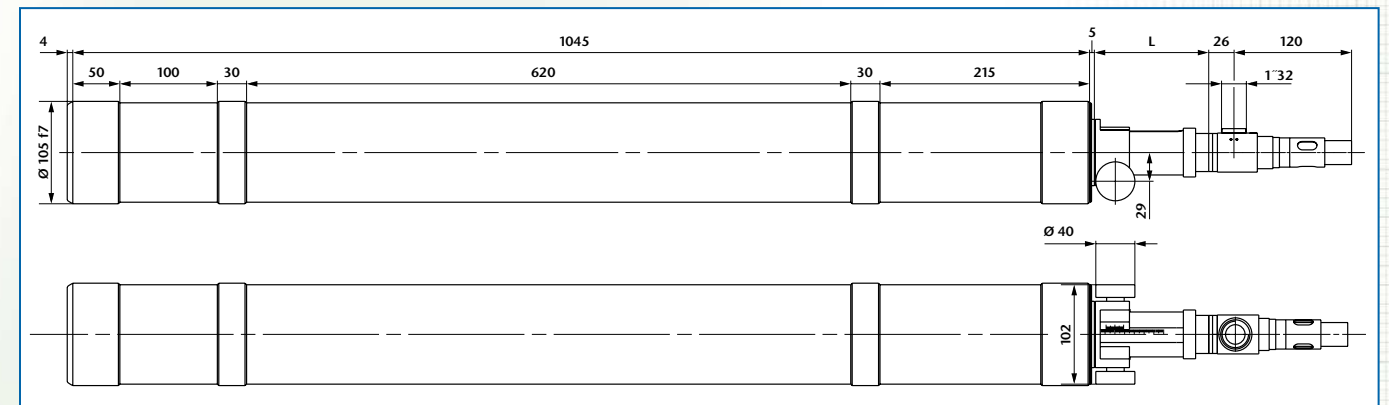
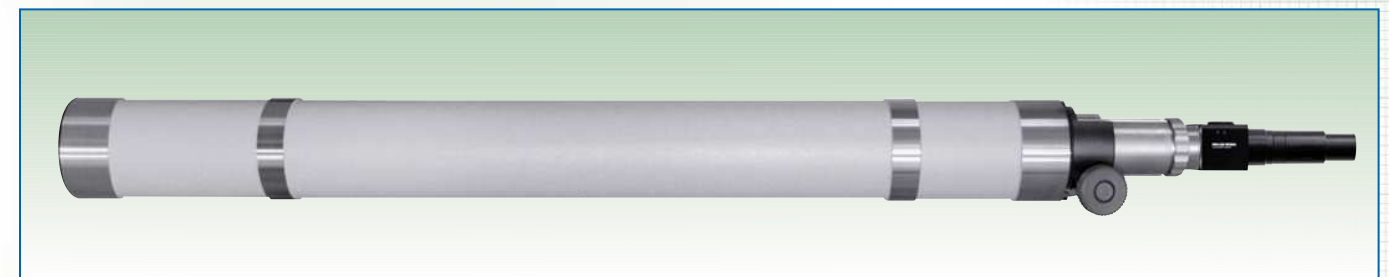

Ord.-No.	Description	Focal length	Free aperture	Tube extension	Meas. range*	Distance range	L
229 486	AKRV 1100/105/±50 CCD	1100	78	±50	x:0,20° y:0,14°	-∞...-23,7 m 25,8 m...+∞	177±50
229 487	AKRV 1100/105/+100 CCD	1100	78	+100	x:0,20° y:0,14°	13,2 m...+∞	117 <sup>+12</sup>
229 488	AKRV 1100/105/-100 CCD	1100	78	-100	x:0,20° y:0,14°	-∞...-12,0 m	117 <sup>-12</sup>

\* mit 2/3" CCD-Kamera